

Cables and connectors

Preassembled cables

M23 connection technology

With connector, 12-pin



**Female connector with coupling nut,
conting direction of the female contacts cw**

PVC cable, 6 x 2 x 0.14 mm² [AWG25] + shield
seawater resistant, recyclable, LABS free,
acid/alkali/oil/ozon/UV resistant

Single-ended

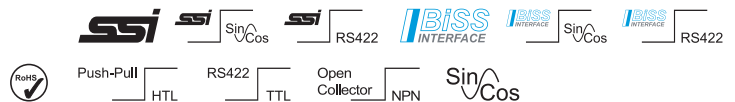

Order details

Order no.

Cable length	1 m [3.28']	8.0000.6901.0001
	2 m [6.56']	8.0000.6901.0002

	xx m	8.0000.6901.00xx
	standard cable length (further on request)	xx = length in meters: 1, 2, 3, 5, 8, 10, 12, 15, 20, 25, 30

Technical data

Connector	
material housing	metal
protection	IP67
Wire cross sections	6 x 2 x 0.14 mm ² [AWG25] twisted pair conductors+ shield
Working temperature range	
flexible installation	-5 °C ... +70 °C [+23 °F ... +158 °F]
fixed installtion	-30 °C ... +80 °C [-22 °F ... +176 °F]
Bending radius cable min.	
flexible installation	110 mm [4.33"]
fixed installtion	75 mm [2.95"]
Cable sheath	
cable diameter approx.	7.3 mm ±0.2 mm
material sheath	PVC

Dimensions in mm [inch]

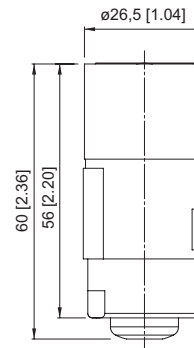

Connections

Terminal assignment

Pin female contacts:	1	2	3	4	5	6	7	8	9	10	11	12
Core color:	PK	RD/BU	BU	RD	GN	YE	-	GY	-	WH	GY/PK	BN

Shield on housing

Plug-in face

conting direction: female contacts cw

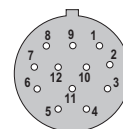

Suitable for our series

Encoder incremental	Encoders singleturn	Encoders multiturn
5000 / 5020	5853 / 5873	5863 / 5883
5803 / 5823	5853FSx / 5873FSx	5863FSx / 5883FSx
5805 / 5825		
KIS50 / KIH50		
5814 / 5834		
5814FSx / 5834FSx		
A020 / A02H		
H120		