

# Cables and connectors

**Preassembled cables**

**M23 connection technology**

**With connector, 12-pin**



**Female connector with coupling nut,  
conting direction of the female contacts cw**

**PUR cable, 10 x 0.14 mm<sup>2</sup> [AWG25] + 2 x 0.50 mm<sup>2</sup> [AWG20] + shield**  
 flame retardant, seawater resistant, recyclable, LABS free, acid/  
 alkali/oil/ozon/UV resistant, halogen/silicone free, hydrolysis proof,  
 drag chain-adapted, torsion resistant, welding sparks resistant

**Single-ended**

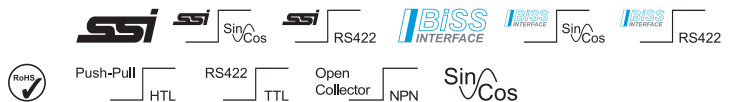

**Order details**

Order no.

Cable length	1 m [3.28']	<b>8.0000.6101.0001</b>
	2 m [6.56']	<b>8.0000.6101.0001</b>
	...	...
	xx m	<b>8.0000.6101.00xx</b>
	standard cable length (further on request)	xx = length in meters: 1, 2, 3, 5, 8, 10, 12, 15, 20, 25, 30

**Technical data**

<b>Connector</b>	
material housing	metal
protection	IP67
<b>Wire cross sections</b>	10 x 0.14 mm <sup>2</sup> [AWG25] + 2 x 0.5 mm <sup>2</sup> [AWG20] + shield
<b>Working temperature range</b>	
flexible installation	-30 °C ... +80 °C [-22 °F ... +176 °F]
fixed installation	-50 °C ... +90 °C [-58 °F ... +194 °F]
<b>Bending radius cable min.</b>	
flexible installation	50 mm [1.97"]
fixed installation	35 mm [1.38"]
<b>Cable sheath</b>	
cable diameter approx.	6.9 mm ±0.3 mm
material sheath	PUR

Dimensions in mm [inch]

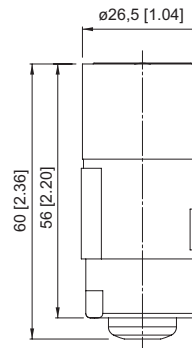

**Connections**

Terminal assignment

Pin female contacts:	1	2	3	4	5	6	7	8	9	10	11	12
Core color:	PK	BN	BU	RD	GN	YE	-	GY	-	WH 0.5 mm <sup>2</sup>	WH 0.5 mm <sup>2</sup>	BN 0.5 mm <sup>2</sup>

Shield on housing

Plug-in face

conting direction: female contacts cw

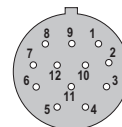

**Suitable for our series**

Encoder  
incremental

5803 / 5823  
 5805 / 5825  
 5814FSx / 5834FSx  
 H120