

Accessories

Front bezel

Details

Dimensions / Details

Dimensions in mm [inch]

Order no.

Front bezel type F1B

for plug-in counters B 1x.0x and HB 2x.0x in socket box type 945.2

description:

- for cut-out 54 x 29 mm [2.13 x 1.14"]
- screw mounting

suitable for:

B 1x.0x, HB 2x.0x

beige

black

6.0000.D100.0004

6.0000.D100.0002

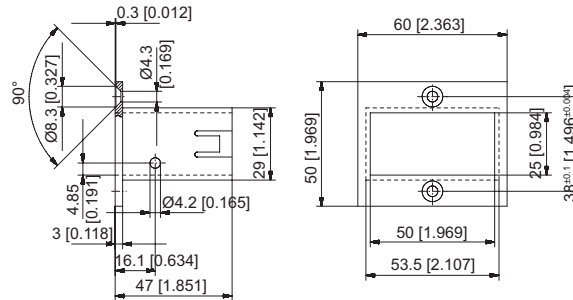

Front bezel type F2B

for plug-in counters BVa 15.0x in socket box type 946.1 or 2 x B- or HB counters in socket box type 945.2

description:

- for cut-out 54 x 54 mm [2.13 x 2.13"]
- screw mounting

suitable for:

BVa 15.0x

beige

black

6.0000.D200.0004

6.0000.D200.0002

