

# Connection technology

## Sub-D connection technology Cordsets, pre-assembled

With Sub-D connector + M23 connector

Working temp. -30°C ... +80°C [-22°F ... +176°F]

Order no.

**Sub-D female connector, 9-pin, cable outlet 70°  
+ M23 female connector with coupling nut,  
12 pin**

Cable: PVC, 3 x 2 x 0.25 mm<sup>2</sup> [AWG 23]  
Housing Sub-D: ABS, metalized, IP20  
Housing M23: metal, IP67

suitable for our series:

5000 / 5020    5006 / 5026  
5814 / 5834    5814FSx / 5834FSx  
5821

SMC1.1, SMC2.2  
(for SinCos signals – terminal X6, X7)

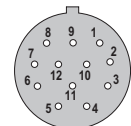
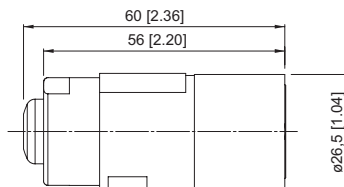
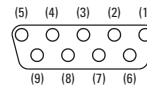
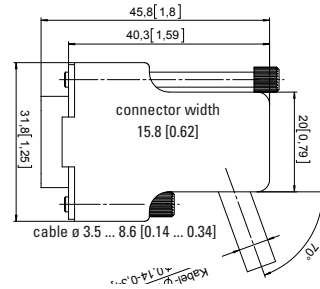

pin socket  
assignment cw

### Terminal assignment

Pin Sub-D:	5	4	1	9	3	2	PH <sup>2)</sup>
Pin M23:	10	12	5	6	8	1	PH <sup>2)</sup>
pins arranged below each other are connected internally							

### cable length<sup>1)</sup>

2 m [6.56']	<b>8.0000.6V00.0002.0085</b>
5 m [16.40']	<b>8.0000.6V00.0005.0085</b>
10 m [32.81']	<b>8.0000.6V00.0010.0085</b>
15 m [49.21']	<b>8.0000.6V00.0015.0085</b>

1) Other cable lengths on request.  
2) Shield on housing.