

Cables and connectors

Preassembled cables

M23 connection technology

With connector, 12-pin



**Female connector with coupling nut,
conting direction of the female contacts cw**

PUR cable, 10 x 0.14 mm² [AWG25] + 2 x 0.50 mm² [AWG20] + shield
 flame retardant, seawater resistant, recyclable, LABS free, acid/
 alkali/oil/ozon/UV resistant, halogen/silicone free, hydrolysis proof,
 drag chain-adapted, torsion resistant, welding sparks resistant

Single-ended

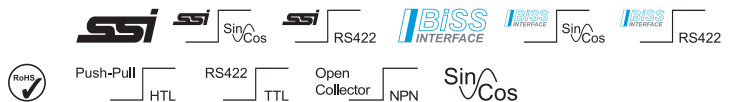

Order details

Order no.

Cable length	1 m [3.28']	8.0000.6101.0001
	2 m [6.56']	8.0000.6101.0002

	xx m	8.0000.6101.00xx
	standard cable length (further on request)	xx = length in meters: 1, 2, 3, 5, 8, 10, 12, 15, 20, 25, 30

Technical data

Connector	
material housing	metal
protection	IP67
Wire cross sections	10 x 0.14 mm ² [AWG25] + 2 x 0.5 mm ² [AWG20] + shield
Working temperature range	
flexible installation	-30 °C ... +80 °C [-22 °F ... +176 °F]
fixed installation	-50 °C ... +90 °C [-58 °F ... +194 °F]
Bending radius cable min.	
flexible installation	50 mm [1.97"]
fixed installation	35 mm [1.38"]
Cable sheath	
cable diameter approx.	6.9 mm ±0.3 mm
material sheath	PUR

Dimensions in mm [inch]

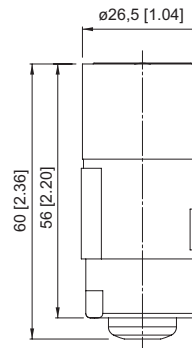

Connections

Terminal assignment

Pin female contacts:	1	2	3	4	5	6	7	8	9	10	11	12
Core color:	PK	BN	BU	RD	GN	YE	-	GY	-	WH 0.5 mm ²	WH 0.5 mm ²	BN 0.5 mm ²

Shield on housing

Plug-in face

conting direction: female contacts cw

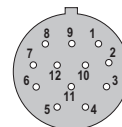

Suitable for our series

Encoder
incremental

5803 / 5823
 5805 / 5825
 5814FSx / 5834FSx
 H120