

Cables and connectors

Preassembled cables

M23 connection technology

With connector, 12-pin



**Female connector with coupling nut,
conting direction of the female contacts cw**

**PE-X cable,
5 x 2 x 0.14 mm² [AWG25] + 2 x 0.50 mm² [AWG20] + shield**

Single-ended

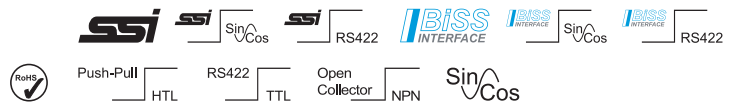

Order details

Order no.

Cable length	1 m [3.28']	8.0000.6E01.0001
	2 m [6.56']	8.0000.6E01.0002

	xx m	8.0000.6E01.00xx
	standard cable length (further on request)	xx = length in meters: 1, 2, 3, 5, 8, 10, 12, 15, 20, 25, 30

Technical data

Connector	
material housing	metal
protection	IP67
Wire cross sections	5 x 2 x 0.14 mm ² [AWG25] + 2 x 0.5 mm ² [AWG20] twisted pair conductors + shield
Working temperature range	
flexible installation	-25 °C ... +110 °C [-13 °F ... +230 °F]
fixed installation	-40 °C ... +135 °C [-40 °F ... +275 °F]
Bending radius cable min.	
flexible installation	90 mm [3.54"]
fixed installation	70 mm [2.75"]
Cable sheath	
cable diameter approx.	8.5 mm ±0.9 mm
material sheath	PE-X, halogenfree

Dimensions in mm [inch]

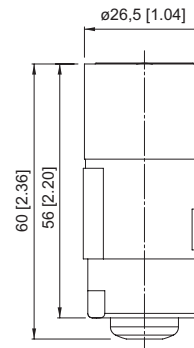

Connections

Terminal assignment

Pin female contacts:	1	2	3	4	5	6	7	8	9	10	11	12
Core color:	PK	BN	BU	RD	GN	YE	-	GY	-	WH 0.5 mm ²	WH	BN 0.5 mm ²

Shield on housing

Plug-in face

conting direction: female contacts cw

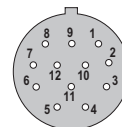

Suitable for our series

Encoder incremental	Encoders singleturn	Encoders multiturn
5000 / 5020	5853 / 5873	5863 / 5883
5803 / 5823	5853FSx / 5873FSx	5863FSx / 5883FSx
5805 / 5825		
KIS50 / KIH50		
5814 / 5834		
5814FSx / 5834FSx		
A020 / A02H		
H120		