

# Hour meters / timers, electromechanical

<b>Timers, round design</b>	<b>With LED run indicator (AC+DC)</b>	<b>HR47</b>
-----------------------------	---------------------------------------	-------------



The hour meter HR47 with run indicator feature a very high shock resistance.

These panel-mount counters for round panel cut-outs can be used in many different fields of application. These non-resettable counters are very robust and extremely tamper-proof.

### Characteristics

- 7-digit hour meter.
- For voltage ranges 10 ... 80 V DC, 100 ... 130 V AC and 187 ... 264 V AC.
- Magnified large figures.
- Protection IP65 on the front and rear sides.
- Suitable for any mounting position.
- Without reset, and thus tamper-proof.
- High shock and impact resistance.

### Benefits

- With run indicator (AC version), optional LED (DC version).
- For panel cut-out  $\varnothing$  50.5 mm with front panel dimensions  $\varnothing$  58 mm.
- Simple and secure mounting with screwed clamping clip.



### Applications

General time measurement, construction machinery and industrial trucks, small appliances, UV lamps, display panels in vehicles, compressors, air-conditioning equipment, etc..

## Type series

Description	Mounting	Type
Timer, round	Clamping clip fixing, screw-on	<b>HR47</b>

## Accessories

	Type / size	Description	Order no.
<b>Mounting support</b>		for round counters with cutout $\varnothing$ 53 mm	black <b>N510199</b>
<b>Gasket counter</b>	$\varnothing$ 58 mm [2.28"]	for cut-out $\varnothing$ 50 mm	<b>N511182</b>
<b>Adapter and anti-vibration set</b>	 $\varnothing$ 80 mm [3.15"]	for cut-out $\varnothing$ 71 mm	black <b>255319</b>

# Hour meters / timers, electromechanical

## Timers, round design With LED run indicator (AC+DC) HR47

Technical data	
<b>Electrical connection</b>	screw terminal for flat pin 6.3 x 0.8 mm [0.25 x 0.031"]
<b>Power consumption</b>	10 ... 80 V DC max. 720 mW 100 ... 130 V AC, 60 Hz max. 1.1 VA 187 ... 264 V AC, 50 Hz approx. 1.2 VA
<b>Rated voltages</b>	AC (50 or 60 Hz) 100 ... 130/187 ... 264 V AC, DC 10 ... 80 V DC
<b>On time</b>	100 %
<b>Number of digits</b>	AC 7: 99999.99 h DC 7: 999999.9 h
<b>Resolution</b>	AC 0.01 h equals 36 s DC 0.1 h equals 6 min
<b>Count mode</b>	adding
<b>Height of figures</b>	4 mm [0.16"]
<b>Color of figures</b>	hours white on black decimal position 50 Hz - red on black 60 Hz - red on white
<b>Count position at delivery</b>	1.00 - 1.02
<b>Operating temperature</b>	AC -25 °C ... +80 °C [-13 °F ... +176 °F] (non-condensing) DC -20 °C ... +70 °C [-4 °F ... +158 °F] (non-condensing)
<b>Relative humidity</b> at +25 °C [+77 °F]	≤ 80 % (non-condensing)
<b>Altitude</b>	up to 2000 m [6562']
<b>Mounting position</b>	any
<b>Protection</b>	IP65, EN 60529 (except the connections)

<b>Housing</b>	plastic PC (Polycarbonate)
<b>Accuracy</b>	AC ±0.02 % DC ±0.002 %
<b>Weight</b>	approx. 50 g [1.76 oz]
<b>Run indicator</b>	AC fast rotating wheel in viewing window DC optional LED
<b>Test voltage</b>	2000 V AC, 50 Hz for AC version
<b>EMC standards</b>	EN 55011 class B EN 61000-6-2, EN 61000-6-3
<b>Device safety</b>	designed to EN 61010 part 1 protection class 2 application area pollution level 2

**Options**  
Counter for ø 52 mm [0.20"] with screwed clamping bracket or screw thread on request

**Approvals**  
CE compliant in accordance with  
EMC Directive 2014/30/EU  
RoHS Directive 2011/65/EU  
Low Voltage Directive 2014/35/EU

### Timer, round Type HR47

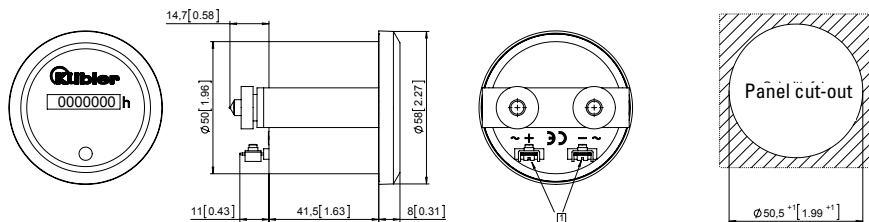

1) Electrical connection: +/- left, -/~ right (rear view)

Front bezel thickness max. 6 [0.24] without having to shorten the clamping bracket

Type	Display	Voltage	Art. no.		
			10 ... 80 V DC	100 ... 130 V 60 Hz	187 ... 264 V 50 Hz
HR47	7 digits	V AC, with run indicator		3.474.901.084 1)	3.474.901.075
	7 digits	V DC, without run indicator	3.474.901.373 1)		
	7 digits	V DC, with run indicator	3.474.911.373 1)		
			further types on request		