

# Hour meters / timers, electromechanical

<b>Standard timers</b>	<b>9999.99 h / 99999.9 h with reset (AC+DC)</b>	<b>HB26</b>
------------------------	---	-------------



The timer HB26 with reset measure time ranges up to max. 99999.9 h or 9999.99 h.

These panel-mount counters can be used in many different fields of application.

### Characteristics

- 6-digit hour meter without reset.
- High shock and impact resistance.
- Magnified large figures; height 4.5 mm.
- Data retention in case of power failure.
- Long service life.
- Plug-in versions.
- Counter without front bezel for mounting in front bezel F1B and F2B and for combination in 50 x 25 mm size with socket box 945.2.

### Benefits

- Can be combined with preset counter BVa, and with pulse counter B1x.
- Can be equipped with various sealing covers to protect the counter against dust, dirt and moisture.
- Key-locking 0-reset.

### Applications

General time measurement, maintenance intervals for measuring instruments (respiration units, oxygen, dialysis), small appliances, UV lamps, display panels in vehicles.

### Type series

#### Description

Screw mounting, 56 x 40 mm [2.20 x 1.57"]

Clip mounting, 53 x 28 mm [2.09 x 1.10"]

Plug-in for socket box 945.2 and front bezel F1B

#### Type

**HB26.11**

**HB26.21**

**HB26.01.3**

#### Options

- Different voltages
- Extended temperature range on request
- Flat pin 0.8 x 6.3 mm [0.031 x 0.25"] without flat push on connectors: Art.-Nr. 3.168.X11.XXX
- Flat pin 0.8 x 2.8 mm [0.031 x 0.11"] with flat push on connectors: Art.-Nr. 3.167.X11.XXX
- Lockable 0-reset: Art.-Nr. 3.160.XX7.XXX  
The button can be unlocked by means of the key



# Hour meters / timers, electromechanical

<b>Standard timers</b>	<b>9999.99 h / 99999.9 h with reset (AC+DC)</b>	<b>HB26</b>
------------------------	---	-------------

## Accessories / Mounting examples

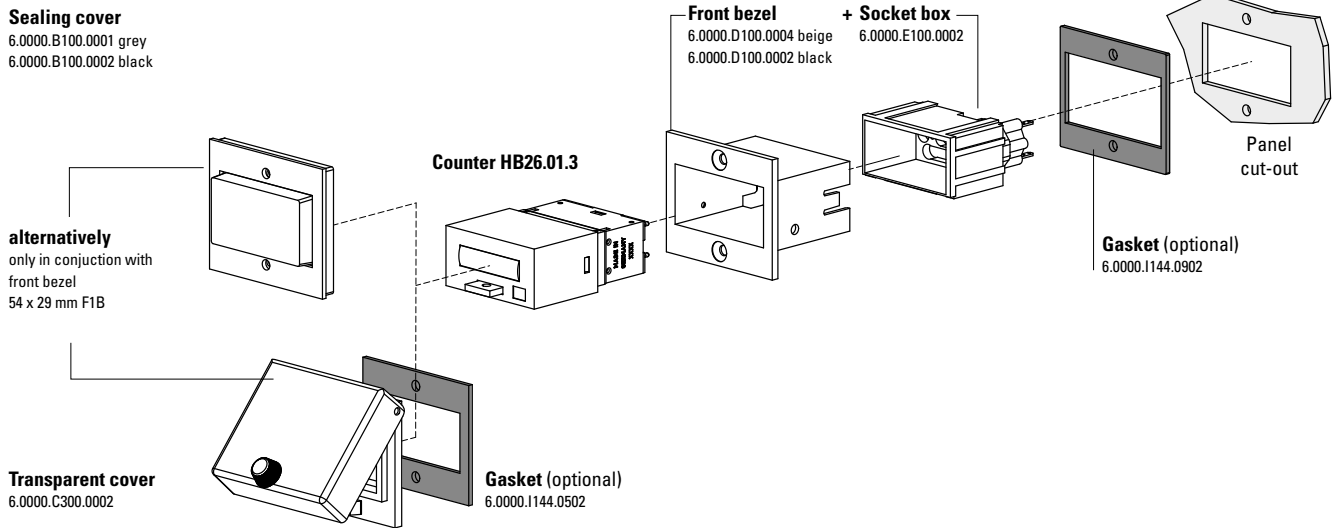

		Type / size	Description		Order no.	suitable gasket
<b>Front bezel</b>		<b>F1B</b>	for 1x counter HB26.01.3 for cut-out 54 x 29 mm [2.13 x 1.14"] (only in conjunction with socket box G008434)	beige black	<b>6.0000.D100.0004</b> <b>6.0000.D100.0002</b>	<b>6.0000.I144.0902</b>
		<b>F2B</b>	for 2x counter HB26.01.3 for cut-out 54 x 54 mm [2.13 x 2.13"] (only in conjunction with 2 x socket box G008434)	beige black	<b>6.0000.D200.0004</b> <b>6.0000.D200.0002</b>	<b>6.0000.I154.1002</b>
<b>Socket box</b>		<b>945.2</b>	for plug-in connection in front bezel F1B	black	<b>6.0000.E100.0002</b>	–
<b>Sealing cover IP65</b>		<b>K1</b>	for counter HB26.01.3 in conjunction with front bezel F1B	transp. /grey transp. /black	<b>6.0000.B100.0001</b> <b>6.0000.B100.0002</b>	–
		<b>K2</b>	only in conjunction with front bezel F2B (for 2x counter HB26.01.3)	transp. /grey transp. /black	<b>6.0000.B200.0001</b> <b>6.0000.B200.0002</b>	
<b>Transparent cover IP65</b>		<b>1 Dv</b>	cover lockable for counter HB26.01.3 in conjunction with front bezel F1B	transp. /black	<b>6.0000.C300.0002</b>	<b>6.0000.I144.0502</b>
		<b>2 Dv</b>	cover lockable only in conjunction with front bezel F2B	transp. /black	<b>6.0000.C100.0002</b>	
		<b>2 Dvs</b>	cover key lockable only in conjunction with front bezel F2B	transp. /black	<b>6.0000.C200.0002</b>	
<b>Gasket counter</b>			56 x 40 mm [2.20 x 1.57"] 53 x 28 mm [2.09 x 1.10"]	HB26.11 HB26.21	<b>6.0000.I113.0502</b> <b>6.0000.I082.0502</b>	
<b>Mounting frame</b>		<b>cut-out 50 x 25 mm [1.97 x 0.98"]</b>	via adapter T008180 for snap-on mounting on 35 mm [1.38"] top-hat DIN rail	chromated	<b>6.0000.F300.0006</b>	–
<b>Enclosure blind</b>		<b>48 x 24 mm [1.89 x 0.94"]</b>	for cut-out 50 x 25 mm [1.97 x 0.98"], for counter 53 x 28 mm [2.09 x 1.10"]	black	<b>6.0000.H200.0002</b>	–
<b>DIN rail mount</b>		<b>SR 1</b>	for snap-on mounting on 35 mm [1.38"] top-hat DIN rail		<b>6.0000.G100.0000</b>	
		<b>SR 2</b>	for 2x HB26		<b>6.0000.G200.0000</b>	

# Hour meters / timers, electromechanical

<b>Standard timers</b>	<b>9999.99 h / 99999.9 h with reset (AC+DC)</b>	<b>HB26</b>
------------------------	---	-------------

## Technical data

Electrical characteristics			Options		
<b>Electrical connection</b>	cable	2 x 0.5 mm <sup>2</sup> [AWG20], NYFAZ, 0.5 m [1.64'] long AC: grey/grey, DC: red +, black –	Different voltages and extended temperature range on request		
	type HB26.01.3	round pins ø 1.6 mm [0.063"] (plugs into socket box type 945.2)	Flat pin 0.8 x 6.3 mm [0.031 x 0.25"] without flat push on connectors	Art. no. 3.168.X11.XXX	
<b>Power consumption</b>	10 ... 30 V DC	approx. 500 mW	Flat pin 0.8 x 2.8 mm [0.031 x 0.11"] with flat push on connectors	Art. no. 3.167.X11.XXX	
	36 ... 80 V DC	approx. 900 mW	Key-locking 0-reset	Art. no. 3.160.XX7.XXX	
	100 ... 130 V DC	approx. 750 mW			
	20 ... 30 V AC	approx. 0.3 VA			
	42 ... 48 V AC	approx. 0.25 VA			
	100 ... 130 V AC	approx. 0.6 VA			
	187 ... 264 V AC	approx. 1.2 VA			
	360 ... 440 V AC	approx. 1.65 VA			
<b>Rated voltages</b>	AC (50 or 60 Hz)	20 ... 30 / 42 ... 48 / 100 ... 130 / 187 ... 264 / 360 ... 440 V AC			
	DC	10 ... 30 / 36 ... 80 / 100 ... 130 V DC			
<b>Accuracy</b>	AC	supply frequency + 30 ms			
	DC	< 0.003 % (at 24 h)			
<b>Device safety</b>	designed to protection class	EN 61010 part 1 2			
	application area	pollution level 2			

General technical data		
<b>Display</b>	number of digits	6, AC: 9999.99 h, DC: 99999.9 h
	height of figures	4.5 mm [0.17"]
	color of figures	white and red on black
<b>Operating temperature</b>		-15 °C ... +50 °C [+5 °F ... +122 °F] (non-condensing)
<b>Relative humidity</b> at +30 °C [+86 °F]		≤ 80 % (non-condensing)
<b>Altitude</b>		up to 2000 m [6562']
<b>Mounting position</b>		any

Mechanical characteristics		
<b>Housing</b>		plastic PC (Polycarbonate)
<b>Protection</b>		IP41 (front side)
	with flexible sealing cover K1	IP54 (front side)
	with transparent cover Dv., Dvs	IP55 (front side)
<b>Weight</b>		approx. 45 g [1.59 oz]

# Hour meters / timers, electromechanical

**Standard timers**      **9999.99 h / 99999.9 h with reset (AC+DC)**      **HB26**

**Screw mounting, 56 x 40 [2.20 x 1.57]**  
**Type HB26.11**

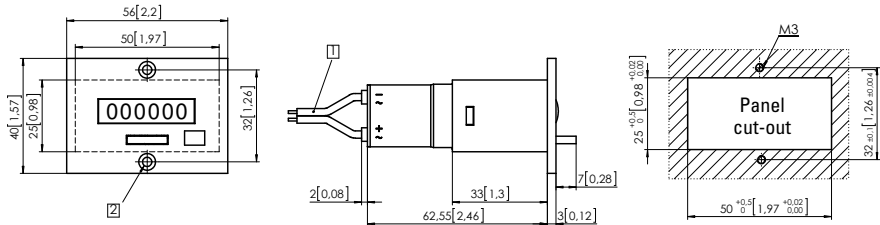

1 Connection cable, 2 x 0.5 mm<sup>2</sup> [AWG20], NYFAZ, 0.5 m [1.64'] long    2 Countersinking Af3, DIN 74

Type	Display	Voltage	Art. no.						
			10 ... 30 V	20 ... 30 V	36 ... 80 V	42 ... 48 V	100 ... 130 V	187 ... 264 V	360 ... 440 V
HB26.11	6 digits	AC (50 Hz)		3.160.111.071		3.160.111.072	3.160.111.074	3.160.111.075	3.160.111.079
	6 digits	AC (60 Hz)		3.160.111.081		3.160.111.082	3.160.111.084	3.160.111.085	3.160.111.089
	6 digits	DC	3.160.111.351		3.160.111.353		3.160.111.381		

**Clip mounting, 53 x 28 [2.09 x 1.10]**  
**Type HB26.21**

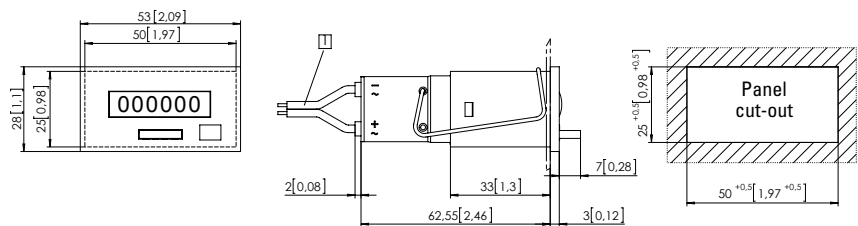

1 Connection cable, 2 x 0.5 mm<sup>2</sup> [AWG20], NYFAZ, 0.5 m [1.64'] long

Type	Display	Voltage	Art. no.						
			10 ... 30 V	20 ... 30 V	36 ... 80 V	42 ... 48 V	100 ... 130 V	187 ... 264 V	360 ... 440 V
HB26.21	6 digits	AC (50 Hz)		3.160.211.071		3.160.211.072	3.160.211.074	3.160.211.075	3.160.211.079
	6 digits	AC (60 Hz)		3.160.211.081		3.160.211.082	3.160.211.084	3.160.211.085	3.160.211.089
	6 digits	DC	3.160.211.351		3.160.211.353		3.160.211.381		
<b>Stock types:</b>			187... 264 V AC, flat pin 0.8 x 2.8 mm [0.031 x 0.11"]				3.167.211.075		
			10 ... 30 V DC, flat pin 0.8 x 2.8 mm [0.031 x 0.11"]				3.167.211.351		

# Hour meters / timers, electromechanical

<b>Standard timers</b>	<b>9999.99 h / 99999.9 h with reset (AC+DC)</b>	<b>HB26</b>
------------------------	---	-------------

Plug-in for socket box 945.2 and front bezel F1B

Type HB26.01.3

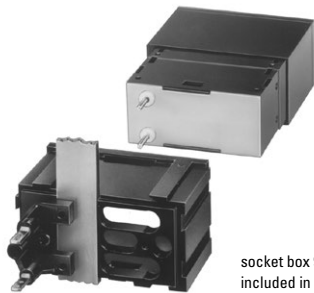

socket box 945.2 not included in delivery

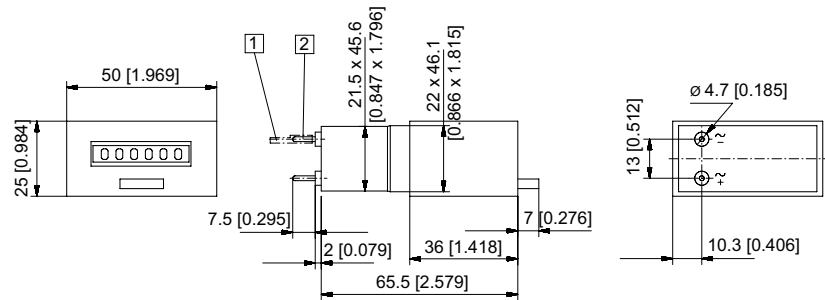

1 Push on connector  $\varnothing$  1.5 [0.059] tinned    2 Round pin  $\varnothing$  1.6 [0.063] tinned

Type	Display	Voltage	Art. no.						
			10 ... 30 V	20 ... 30 V	36 ... 80 V	42 ... 48 V	100 ... 130 V	187 ... 264 V	360 ... 440 V
HB26.01.3	6 digits	AC (50 Hz)		3.165.011.071		3.165.011.072	3.165.011.074	3.165.011.075	3.165.011.079
	6 digits	AC (60 Hz)		3.165.011.081		3.165.011.082	3.165.011.084	3.165.011.085	3.165.011.089
	6 digits	DC	3.165.011.351		3.165.011.353		3.165.011.381		