

Hour meters / timers, electromechanical

Timers, round design

With LED run indicator (AC+DC)

HR47



The hour meter HR47 with run indicator feature a very high shock resistance.

These panel-mount counters for round panel cut-outs can be used in many different fields of application. These non-resettable counters are very robust and extremely tamper-proof.



Characteristics

- 7-digit hour meter.
- For voltage ranges 10 ... 80 V DC, 100 ... 130 V AC and 187 ... 264 V AC.
- Magnified large figures.
- Protection IP65 on the front and rear sides.
- Suitable for any mounting position.
- Without reset, and thus tamper-proof.
- High shock and impact resistance.

Benefits

- With run indicator (AC version), optional LED (DC version).
- For panel cut-out \varnothing 50.5 mm with front panel dimensions \varnothing 58 mm.
- Simple and secure mounting with screwed clamping clip.



Applications

General time measurement, construction machinery and industrial trucks, small appliances, UV lamps, display panels in vehicles, compressors, air-conditioning equipment, etc..

Type series

Description	Mounting	Type
Timer, round	Clamping clip fixing, screw-on	HR47

Accessories

		Type / size	Description		Order no.
Mounting support			for round counters with cutout \varnothing 53 mm	black	N510199
Gasket counter		\varnothing 58 mm [2.28"]	for cut-out \varnothing 50 mm		N511182
Adapter and anti-vibration set		\varnothing 80 mm [3.15"]	for cut-out \varnothing 71 mm	black	255319

Hour meters / timers, electromechanical

Timers, round design	With LED run indicator (AC+DC)	HR47
----------------------	--------------------------------	------

Technical data	
Electrical connection	screw terminal for flat pin 6.3 x 0.8 mm [0.25 x 0.031"]
Power consumption	10 ... 80 V DC max. 720 mW 100 ... 130 V AC, 60 Hz max. 1.1 VA 187 ... 264 V AC, 50 Hz approx. 1.2 VA
Rated voltages	AC (50 or 60 Hz) 100 ... 130/187 ... 264 V AC, DC 10 ... 80 V DC
On time	100 %
Number of digits	AC 7: 99999.99 h DC 7: 999999.9 h
Resolution	AC 0.01 h equals 36 s DC 0.1 h equals 6 min
Count mode	adding
Height of figures	4 mm [0.16"]
Color of figures	hours white on black decimal position 50 Hz - red on black 60 Hz - red on white
Count position at delivery	1.00 - 1.02
Operating temperature	AC -25 °C ... +80 °C [-13 °F ... +176 °F] (non-condensing) DC -20 °C ... +70 °C [-4 °F ... +158 °F] (non-condensing)
Relative humidity at +25 °C [+77 °F]	≤ 80 % (non-condensing)
Altitude	up to 2000 m [6562']
Mounting position	any
Protection	IP65, EN 60529 (except the connections)

Housing	plastic PC (Polycarbonate)
Accuracy	AC ±0.02 % DC ±0.002 %
Weight	approx. 50 g [1.76 oz]
Run indicator	AC fast rotating wheel in viewing window DC optional LED
Test voltage	2000 V AC, 50 Hz for AC version
EMC standards	EN 55011 class B EN 61000-6-2, EN 61000-6-3
Device safety	designed to EN 61010 part 1 protection class 2 application area pollution level 2

Options
Counter for ø 52 mm [0.20"] with screwed clamping bracket or screw thread on request

Approvals
CE compliant in accordance with
EMC Directive 2014/30/EU
RoHS Directive 2011/65/EU
Low Voltage Directive 2014/35/EU

Timer, round Type HR47

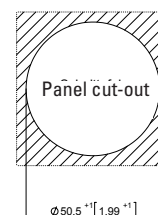
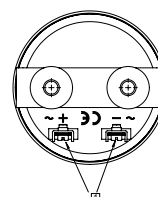
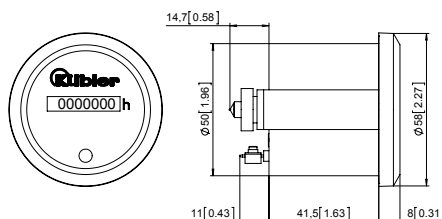

1 Electrical connection: +/- left, -/~ right (rear view)

Front bezel thickness max. 6 [0.24] without having to shorten the clamping bracket

Type	Display	Voltage	Art. no.	10 ... 80 V DC	100 ... 130 V 60 Hz	187 ... 264 V 50 Hz	
HR47	7 digits	V AC, with run indicator			3.474.901.084	3.474.901.075	
	7 digits	V DC, without run indicator	3.474.901.373				further types on request
	7 digits	V DC, with run indicator	3.474.911.373				