

CODIX 550



Available with serial interface and set-up software EzControl!

Your benefit

- Programmable input characteristic curve with up to 24 control points
- MIN/MAX value acquisition and data backup in case of Power Off
- Display-Hold
- Very big keys for use with gloves
- Very bright display
- Input range
0 ... 20 mA, 4 ... 20 mA; 0 ... 10 V
2 ... 10 V; ± 10 V

More advantages

- Auxiliary power supply output for measuring transducer/sensor
- Optional serial interface

Technical data

Miscellaneous Data

Display	5 digit red LED 14.2 mm [0.559"] high
Display range	-19999 ... 99999, with leading zeros suppression
Out of Range Indication	Under-range uuuuu / Over-range ooooo
Data storage	EEPROM, 1 Million storage cycles or 10 Years
Test voltages	EN 61010 Part 1 ; overvoltage category 2, level 2
EMC	Interference emissions EN 55011 Class B Interference resistance EN 61000-6-2

AC power supply 90 ... 260 V AC/max. 6 VA
external fuse 100 mA/T

DC power supply 10 ... 30 V DC, max. 2 W, galvanically isolated
with inverse polarity protection
external fuse 250 mA/T

Mains Hum Filter digital filter 50 Hz or 60 Hz, programmable

Measurement ranges

Current input (DC)	Ranges 0 ... 20 mA, 4 ... 20 mA
Resolution	2 μ A
Voltage drop	max. 2 V at 20 mA
Max. current	50 mA
Voltage input(DC)	Ranges 0 ... 10 V, 2 ... 10 V, ± 10 V
Resolution	1 mV
Input resistance	> 2 M Ω
Max. Voltage	± 30 V
Measuring speed	approx. 2 measurements/s
Linearity	< 0.1% ± 1 Digit for the whole measuring range at an ambient temperature of 20°C [68 °F]
Zero calibration	automatic
Temperature drift	100 ppm/K

Weight	approx. 220 g [7.76 oz]
Protection	IP 65 (front)
Ambient temperature	-20 ... +65 °C [-4 °F ... 149 °F]
Storage temperature	-40 ... +85 °C [-40 °F ... 185 °F]

Digital inputs

Input MPI* Function of the input is dependent on set up
1. Function Display-Hold to stop the instantaneous value

Auxiliary power supply output for measuring transducer/sensor

AC models voltage output 10 V DC $\pm 2\%$, 30 mA and
voltage output 24 V DC $\pm 15\%$, 50 mA

DC models only voltage output 10 V DC $\pm 2\%$, 30 mA

Interface

Available options	RS232, RS485, RS422
Baud rate	600, 1200, 2400, 4800, 9600, 19 200 programmable
Address	00 ... 99 programmable

*Multi Purpose Input

Dimensions:

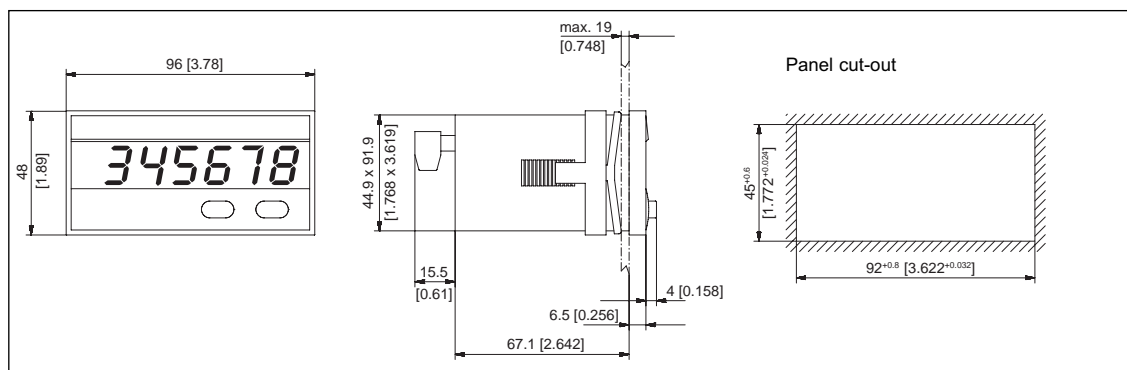

CODIX 550

Connections:

Rear side view

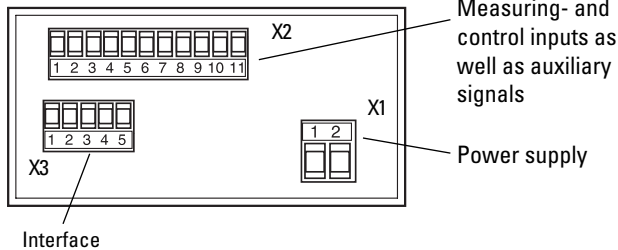

Power supply

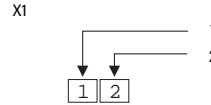

	DC version	AC version
1	10 ... 30 V DC	90 ... 260 V AC (N~)
2	GND4 (0 V DC)	90 ... 260 V AC (L~)

Current measurement



1	Current input (I) 0 ... 20 mA / 4 ... 20 mA
2	GND1 (Analog)

Control inputs and auxiliary power supply (U_{out})

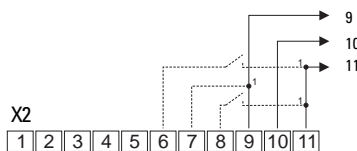

1) Alternatively connect directly to DC supply (galvanic separation of control and measurement inputs)

9	GND3 (for U _{out})
10	U _{out} +10 V/30 mA
11	U _{out} +24 V/50 mA only for power supply 90 ... 260 V AC
8	MP-Input Display-Hold
7	GND2 (MPI)

Voltage measurement

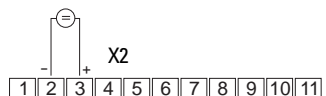

2	GND1 (Analogue)
3	Voltage input (U) 0 ... 10 V, 2 ... 10 V, -10 ... +10 V

Interface

X3 1 2 3 4 5

	RS232	RS485	RS422
1	GND	–	–
2	RxD	DO+/RI+	RI+
3	TxD	DO-/RI-	RI-
4	–	–	DO+
5	–	–	DO-

Serial interface

- For data transmission and documentation
- Connection for programmable logic controllers
- Programming via PC

Delivery includes:

- Process display
- Screw terminal, 2-pole, RM 5.08
- Screw terminal, 11-pole, RM 3.81
- Screw terminal, 5-pole, RM 3.81(*)
- Clamping bracket
- Gasket
- Multilingual operating instructions
- 1 set of self-adhesive symbols

* only with the interface option

Order code:

6.550.012.X0X

