

# Connection Technology

## M23 Connection Technology

## Standard

### Connectors, self-assembly, 12-pin

#### Male connector with external thread IP67

Housing: metal



pin assignment ccw,  
solder connections,  
for cable  $\varnothing$  5,5 ... 10,5 mm

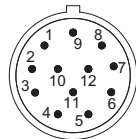

suitable for:  
Versions with cable outlet

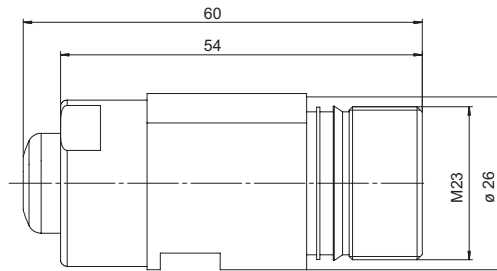

Order No.

**8.0000.5015.0001**

#### Male connector with external thread IP67, central fastening

Housing: metal



pin assignment ccw,  
solder connections,  
for cable  $\varnothing$  5,5 ... 10,5 mm

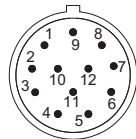

suitable for:  
Versions with cable outlet

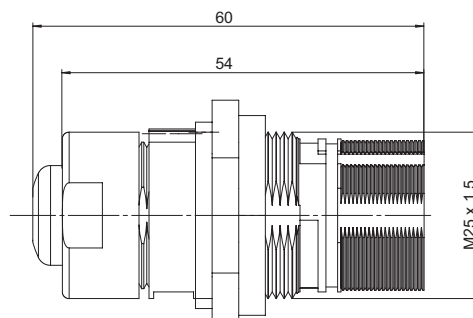

Order No.

**8.0000.5015.0000**

#### Female connector with coupling nut IP67

Housing: metal



pin socket assignment cw,  
solder connections,  
for cable  $\varnothing$  5,5 ... 10,5 mm



suitable for our series:

5000 / 5020	5814 / 5834
580X / 582X	585X / 587X
586X / 588X	9000
908X	A02X

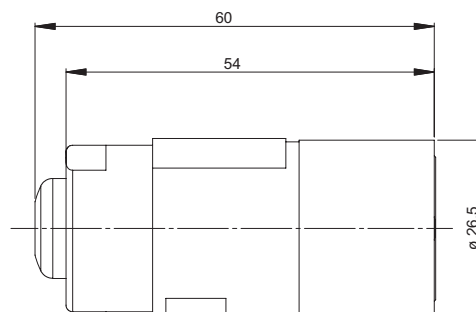

Order No.

**8.0000.5012.0000**

# Connection Technology

## M23 Connection Technology Standard

### Connectors, self-assembly, 12-pin

**Female connector with coupling nut**  
**IP67, EX-Zone 2/22**

Housing: metal

pin socket assignment cw,  
 solder connections,  
 for cable  $\varnothing$  5,5 ... 10,5 mm

suitable for our series:

5000 / 5020	5814 / 5834
580X / 582X	585X / 587X
586X / 588X	9000
908X	A02X

Order No.

**8.0000.5012.0000.Ex**

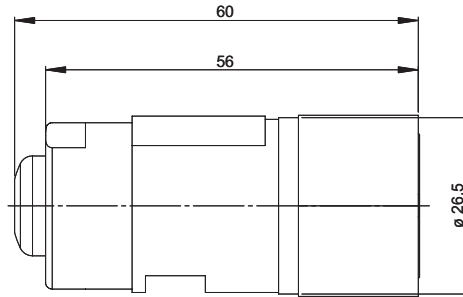

### Connectors, self-assembly, 17-pin

**Female connector with coupling nut**  
**IP67**

Housing: metal

pin socket assignment ccw,  
 solder connections,  
 for cable  $\varnothing$  5,5 ... 10,5 mm

suitable for our series:

5850 / 5870
with parallel interface

Order No.

**8.0000.5042.0000**

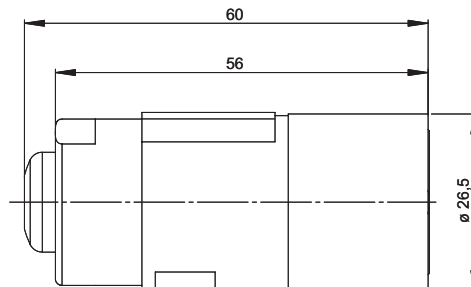

## M23 Connection Technology

## Standard

**Cordsets with connector, pre-assembled, 12-pin, for incremental encoders** (Working temperature range -30°C ... +80°C)

### Female connector with coupling nut IP67

Cable: PUR,  
10 x 0,14 mm<sup>2</sup> +  
2 x 0,5 mm<sup>2</sup>  
Housing: metal

assignment cw

suitable for our series:

5000 / 5020 5814 / 5834  
580X / 582X 9000  
(Push-Pull output)

Cable length

Order No.

2 m **8.0000.6101.0002**  
5 m **8.0000.6101.0005**  
10 m **8.0000.6101.0010**  
15 m **8.0000.6101.0015**

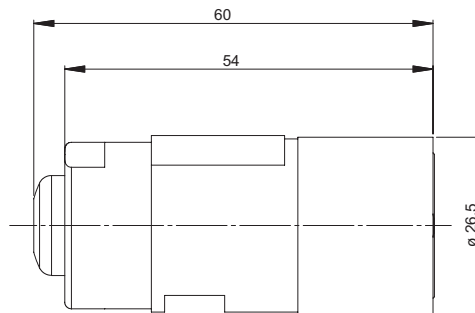

PIN:	1	2	3	4	5	6	7	8	9	10	11	12
cable colour:	PK	BN	BU	RD	GN	YE	-	GY	-	WH 0.5 mm <sup>2</sup>	WH	BN 0.5 mm <sup>2</sup>

### Female connector with coupling nut IP67

Cable: PVC,  
12 x 0,14 mm<sup>2</sup>  
Housing: metal

assignment cw

suitable for our series:

5000 / 5020 5814 / 5834  
580X / 582X 9000  
(Push-Pull output)

Cable length

Order No.

2 m **8.0000.6201.0002**  
5 m **8.0000.6201.0005**  
10 m **8.0000.6201.0010**  
15 m **8.0000.6201.0015**



PIN:	1	2	3	4	5	6	7	8	9	10	11	12
cable colour:	PK	RD-BU	BU	RD	GN	YE	-	GY	-	WH	GY-PK	BN

### Female connector with coupling nut IP67

Cable: PVC,  
6 x 2 x 0,14 mm<sup>2</sup>  
Housing: metal

assignment cw

suitable for our series:

5000 / 5020 5814 / 5834  
580X / 582X 9000  
(RS422 or SinCos interface)

Cable length

Order No.

2 m **8.0000.6901.0002**  
5 m **8.0000.6901.0005**  
10 m **8.0000.6901.0010**  
15 m **8.0000.6901.0015**

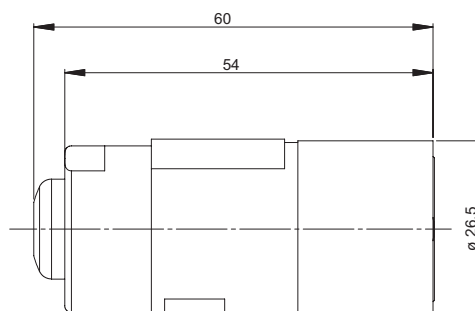

PIN:	1	2	3	4	5	6	7	8	9	10	11	12
cable colour:	PK	RD-BU	BU	RD	GN	YE	-	GY	-	WH	GY-PK	BN

# Connection Technology

## M23 Connection Technology Standard

**Cordsets with connector, pre-assembled, 12-pin, for incremental encoders** (Working temperature range -30°C ... +80°C)

### Female connector with coupling nut IP67

Cable: PVC,  
6 x 2 x 0,14 mm<sup>2</sup>  
Housing: metal

assignment cw

suitable for our series:  
5850 / 5870 5853 / 5873  
5863 / 5883 5862 / 5882  
9081  
(SSI- or analogue interface)

Cable length

Order No.

2 m **8.0000.6901.0002.0031**  
5 m **8.0000.6901.0005.0031**  
10 m **8.0000.6901.0010.0031**  
15 m **8.0000.6901.0015.0031**

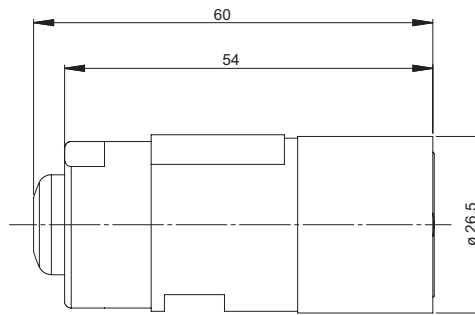

PIN:	1	2	3	4	5	6	7	8	9	10	11	12
cable colour:	WH	BN	GN	YE	GY	PK	BU	RD	BK	VT	GY-PK	RD-BU

### Female connector with coupling nut + male connector with external thread IP67

Cable: PVC,  
6 x 2 x 0,14 mm<sup>2</sup>  
Housing: metal

assignment cw  
assignment ccw

suitable for our series:  
5850 / 5870 5853 / 5873  
5863 / 5883 5862 / 5882  
9081  
(SSI-interface)

Cable length

Order No.

2 m **8.0000.6905.0002.0032**  
5 m **8.0000.6905.0005.0032**  
10 m **8.0000.6905.0010.0032**  
15 m **8.0000.6905.0015.0032**

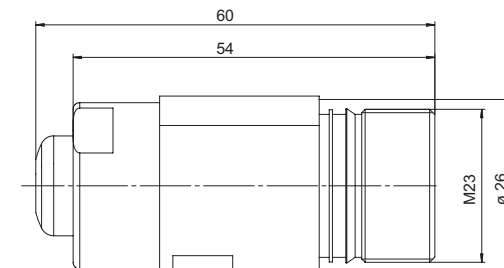
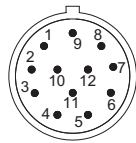
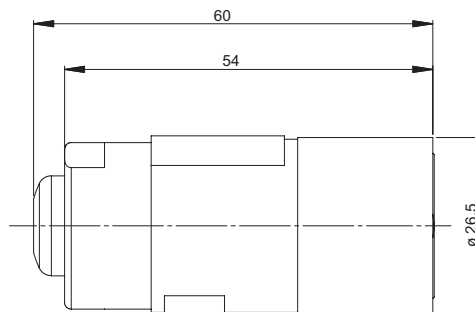

PIN:	1	2	3	4	5	6	7	8	9	10	11	12
cable colour:	WH	BN	GN	YE	GY	PK	BU	RD	BK	VT	GY-PK	RD-BU

## M23 Connection Technology

## Standard

**Cordsets with connector, pre-assembled, 17-pin, for absolute encoders**

(Working temperature range -30°C ... +80°C)

**Female connector with coupling nut  
IP67**

assignment ccw

suitable for our series:  
5850 / 5870    5852 / 5872  
(Parallel interface)

*Cable length*

*Order No.*

Cable: PVC,  
18 x 0,14 mm<sup>2</sup>  
Housing: metal

2 m    **8.0000.6741.0002**  
5 m    **8.0000.6741.0005**  
10 m   **8.0000.6741.0010**  
15 m   **8.0000.6741.0015**

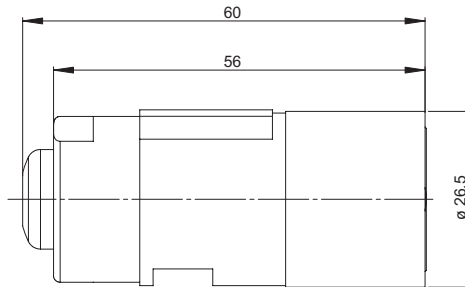

PIN:	1	2	3	4	5	6	7	8	9	10	11	12	13	14	15	16	17
cable colour:	WH	BN	GN	YE	GY	PK	BU	RD	BK	VT	GY-PK	RD-BU	WH-GN	BN-GN	WH-YE	YE-BN	WH-GY