

Connection Technology

M12 Connection Technology Profibus-DP

Connectors, self-assembly, 5-pin

Female connector with coupling nut
Bus in, straight, IP67

Housing: metal



B coded, screw connections,
for cable \varnothing 4 ... 9 mm

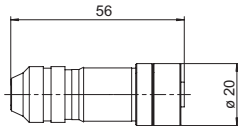
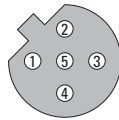

suitable for our series:

5858 / 5878
5868 / 5888
9080

Order No.

05.BMWS 8151-8.5

Male connector with external thread
Bus in, straight, IP67

Housing: metal



B coded, screw connections,
for cable \varnothing 4 ... 9 mm

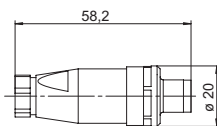
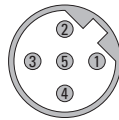

suitable for our series:

5858 / 5878
5868 / 5888
9080

Order No.

05.BMSWS 8151-8.5

Female connector with coupling nut
Bus in, right-angle, IP67

Housing: metal



B coded, screw connections,
for cable \varnothing 4 ... 9 mm

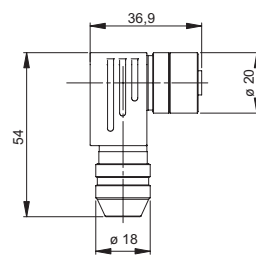
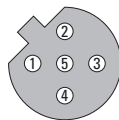

suitable for our series:

5858 / 5878
5868 / 5888
9080

Order No.

05.BMWS 8251-8.5

Male connector with external thread
Bus in, right-angle, IP67

Housing: metal



B coded, screw connections,
for cable \varnothing 4 ... 9 mm

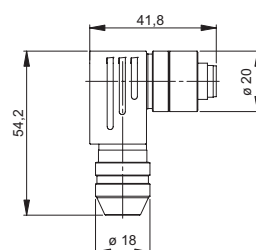

suitable for our series:

5858 / 5878
5868 / 5888
9080

Order No.

05.BMSWS 8251-8.5

M12 Connection Technology

Profibus-DP

Accessories

Terminating resistor straight, IP67

Housing: metal / plastic



B coded

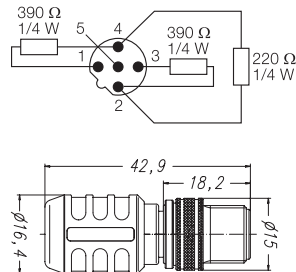

suitable for our series:

5858 / 5878
5868 / 5888
9080

Order No.

05.RSS4.5-PDP-TR

M12 lead-through straight, IP67

Housing: metal



B coded

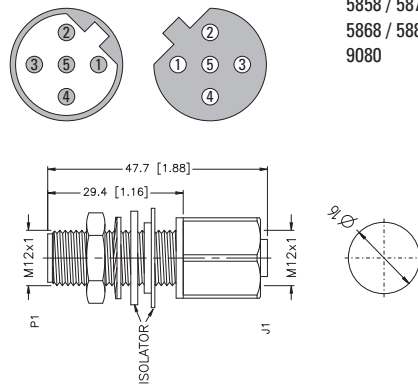

suitable for our series:

5858 / 5878
5868 / 5888
9080

Order No.

05.FKW-FSW45/M12

Connection Technology

M12 Connection Technology Profibus-DP

Connectors, self-assembly, 4-pin, Profibus-DP power supply

Female connector with coupling nut straight, IP67

Housing: plastic



A coded, screw connections, for cable \varnothing 4 ... 6 mm

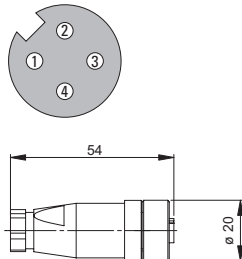

suitable for our series:

5858 / 5878
5868 / 5888
9080

Order No.

05.B8141-0

Male connector with external thread straight, IP67

Housing: metal / plastic



A coded, screw connections, for cable \varnothing 4 ... 6 mm

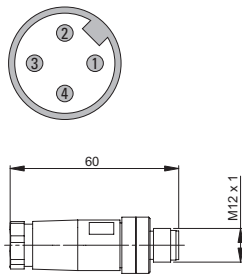

suitable for:
versions with cable outlet

Order No.

05.BS8141-0

Female connector with coupling nut right-angle, IP67

Housing: plastic



A coded, screw connections, for cable \varnothing 4 ... 6 mm

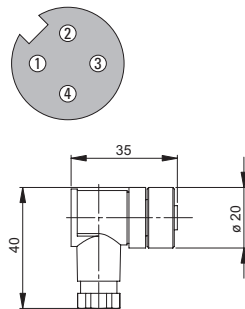

suitable for our series:

5858 / 5878
5868 / 5888
9080

Order No.

05.B8241-0

Male connector with external thread right-angle, IP67

Housing: metal / plastic



A coded, screw connections, for cable \varnothing 4 ... 6 mm

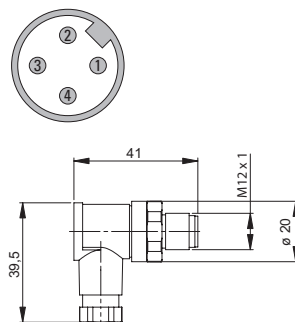

suitable for:
versions with cable outlet

Order No.

05.BS8241-0

M12 Connection Technology

Profibus-DP

Bus cable with connector, pre-assembled, 5-pin

(Working temperature range -30°C ... +80°C)

Female connector with coupling nut Bus in, straight, IP67, single-ended

Cable: PUR, 2 x 0,34 mm²
Housing: metal / plastic



B coded

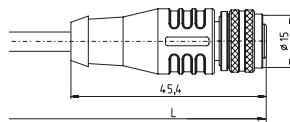
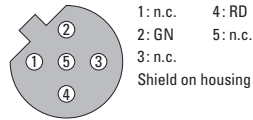

suitable for our series:

5858 / 5878
5868 / 5888
9080

Cable length

6 m
10 m
15 m

Order No.

05.00.6011.3211.006M
05.00.6011.3211.010M
05.00.6011.3211.015M

Male connector with external thread Bus out, straight, IP67, single-ended

Cable: PUR, 2 x 0,34 mm²
Housing: metal / plastic



B coded

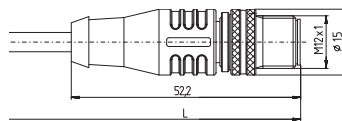
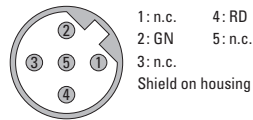

suitable for our series:

5858 / 5878
5868 / 5888
9080

Cable length

6 m
10 m
15 m

Order No.

05.00.6011.3411.006M
05.00.6011.3411.010M
05.00.6011.3411.015M

Female connector with coupling nut Bus in, right-angle, IP67, single-ended

Cable: PUR, 2 x 0,34 mm²
Housing: metal / plastic



B coded

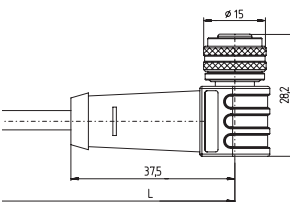
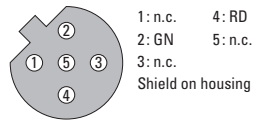

suitable for our series:

5858 / 5878
5868 / 5888
9080

Cable length

6 m
10 m
15 m

Order No.

05.00.6011.3311.006M
05.00.6011.3311.010M
05.00.6011.3311.015M

Male connector with external thread Bus out, right-angle, IP67, single-ended

Cable: PUR, 2 x 0,34 mm²
Housing: metal / plastic



B coded

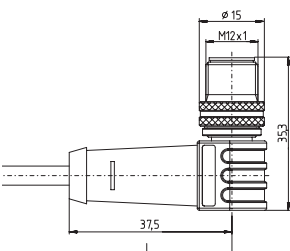
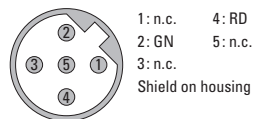

suitable for our series:

5858 / 5878
5868 / 5888
9080

Cable length

6 m
10 m
15 m

Order No.

05.00.6011.3511.006M
05.00.6011.3511.010M
05.00.6011.3511.015M

Connection Technology

M12 Connection Technology Profibus-DP

Bus cable with connector, pre-assembled, 5-pin (Working temperature range -30°C ... +80°C)

**Female connector with coupling nut + male connector with external thread
Bus in/out, straight, IP67**

Cable: PUR, 2 x 0,34 mm²
Housing: metal / plastic



B coded

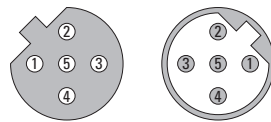

suitable for our series:

5858 / 5878
5868 / 5888
9080

Cable length

2 m
6 m
10 m
15 m

Order No.

05.00.6011.3432.002M
05.00.6011.3432.006M
05.00.6011.3432.010M
05.00.6011.3432.015M

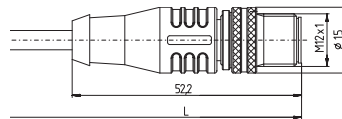
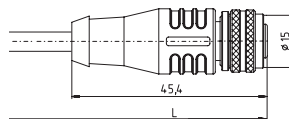

**Female connector with coupling nut + male connector with external thread
Bus in/out, right-angle, IP67**

Cable: PUR, 2 x 0,34 mm²
Housing: metal / plastic



B coded

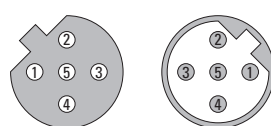

suitable for our series:

5858 / 5878
5868 / 5888
9080

Cable length

2 m
6 m
10 m
15 m

Order No.

05.00.6011.3533.002M
05.00.6011.3533.006M
05.00.6011.3533.010M
05.00.6011.3533.015M

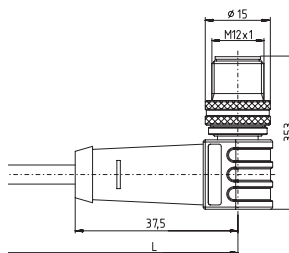
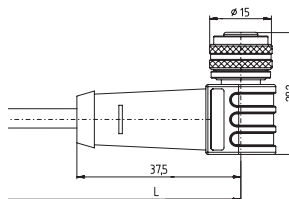

Connection Technology

M12 Connection Technology

Profibus-DP

Bus cable with connector, pre-assembled, Sub-D-connector

(Working temperature range -30°C ... +80°C)

Sub-D connector, Profibus Master single-ended, with terminating resistor

Cable: PUR, 2 x 0,34 mm²
Housing: metal / plastic



Sub-D connector

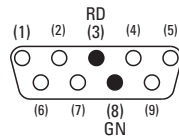

Shield on housing

suitable for our series:

5858 / 5878
5868 / 5888
9080

Cable length

0,5 m
2 m

Order No.

05.00.6011.5511.00M5
05.00.6011.5511.002M

Sub-D connector + M12 female connector with coupling nut Profibus Master, Bus in, with terminating resistor

Cable: PUR, 2 x 0,34 mm²
Housing: metal / plastic



Sub-D connector

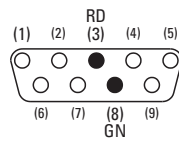

Shield on housing

M12 connector, B coded

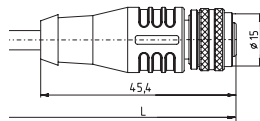
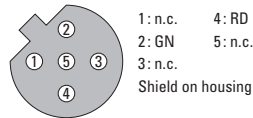

suitable for our series:

5858 / 5878
5868 / 5888
9080

Cable length

0,5 m
2 m

Order No.

05.00.6011.5532.00M5
05.00.6011.5532.002M

Sub-D connector + M12 male connector with external thread Profibus Master, Bus out, with terminating resistor

Cable: PUR, 2 x 0,34 mm²
Housing: metal / plastic



Sub-D connector

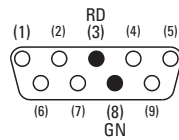

Shield on housing

M12 connector, B coded

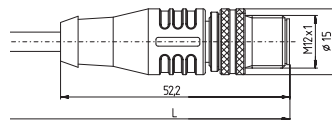
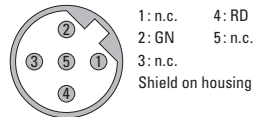

suitable for our series:

5858 / 5878
5868 / 5888
9080

Cable length

0,5 m
2 m

Order No.

05.00.6011.5534.00M5
05.00.6011.5534.002M

Connection Technology

M12 Connection Technology Profibus-DP

Bus cable with connector, pre-assembled, Sub-D-connector (Working temperature range -30°C ... +80°C)

**Sub-D connector +
M12 female connector with coupling nut +
M12 male connector with external thread
Profibus Master, Bus in / Bus out
with terminating resistor**

Cable: PUR, 2 x 0,34 mm²
Housing: metal / plastic



Sub-D connector

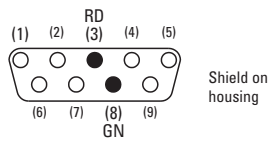

suitable for our series:

5858 / 5878
5868 / 5888
9080

Cable length

2 x 0,5 m
2 x 2 m

Order No.

05.00.6012.5536.00M5
05.00.6012.5536.002M

M12 connector, B coded

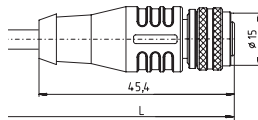
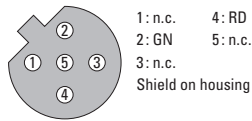

M12 connector, B coded

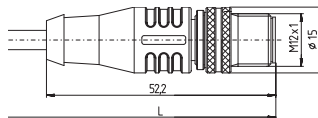
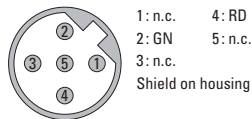

Connection Technology

M12 Connection Technology

Profibus-DP

Bus cable with connector, pre-assembled, 4-pin, Profibus-DP power supply (Working temperature range -30°C ... +90°C)

Female connector with coupling nut straight, single-ended, IP67

Cable: PUR, 4 x 0,34 mm²
Housing: metal / plastic



A coded

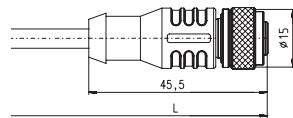
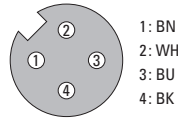

suitable for our series:

5858 / 5878
5868 / 5888
9080

Cable length

2 m
6 m
10 m

Order No.

05.00.6061.6211.002M
05.00.6061.6211.006M
05.00.6061.6211.010M

Female connector with coupling nut + male connector with external thread straight, IP67

Cable: PUR/PVC, 4 x 0,34 mm²
Housing: metal / plastic



A coded

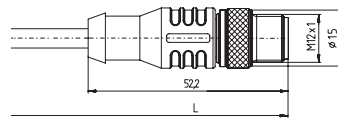
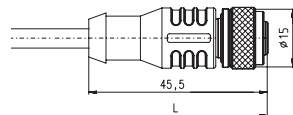
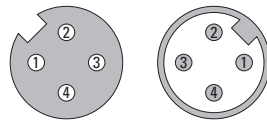

suitable for our series:

5858 / 5878
5868 / 5888
9080

Cable length

2 m
5 m
10 m

Order No.

05.00.6061.6462.002M
05.00.6061.6462.005M
05.00.6061.6462.010M